



- 1** HIDDEN POINT BAR 2.5
HPB 2.5
- 2** HIDDEN POINT BAR 4.0
HPB 4.0
- 3** BAR EXTENSION
BEX
- 4** HIDDEN POINT BAR HOLDER
HPBH
- 5** INSERT OFFSET ROD
IOR
- 6** INSERT SINE BAR
ISB
- 7** INSERT VARIABLE OFFSET ROD
IVOR
- 8** INSERT VARIABLE SINE BAR
IVSB
- 9** REVERSE HIDDEN POINT ADAPTOR
RHPA

HPB - 2.5 and HPBR - 2.5

Used for projecting to a hidden hole or surface. The .2500 hole accepts a 90° target or bar extension. A Starrett 657TW fine adjustment flexible arm magnetic base or equivalent may be used with a Hidden Point Bar Holder (HPBH) when necessary.

HPB - 2.5 and HPBR - 2.5 ORDERING INFORMATION

	FAMILY	"D" DOT DIAMETER	MATERIAL				
HPB/HPBR-2.5 STANDARD BUILD	HPB-2.5 or HPBR-2.5		1144 steel, black oxide finish				
CUSTOMER PROVIDES INFO	■						
REFERENCE NOTES	_____						

HIDDEN POINT BAR and HIDDEN POINT BAR RETRO-REFLECTIVE- 2.5

CAD on file

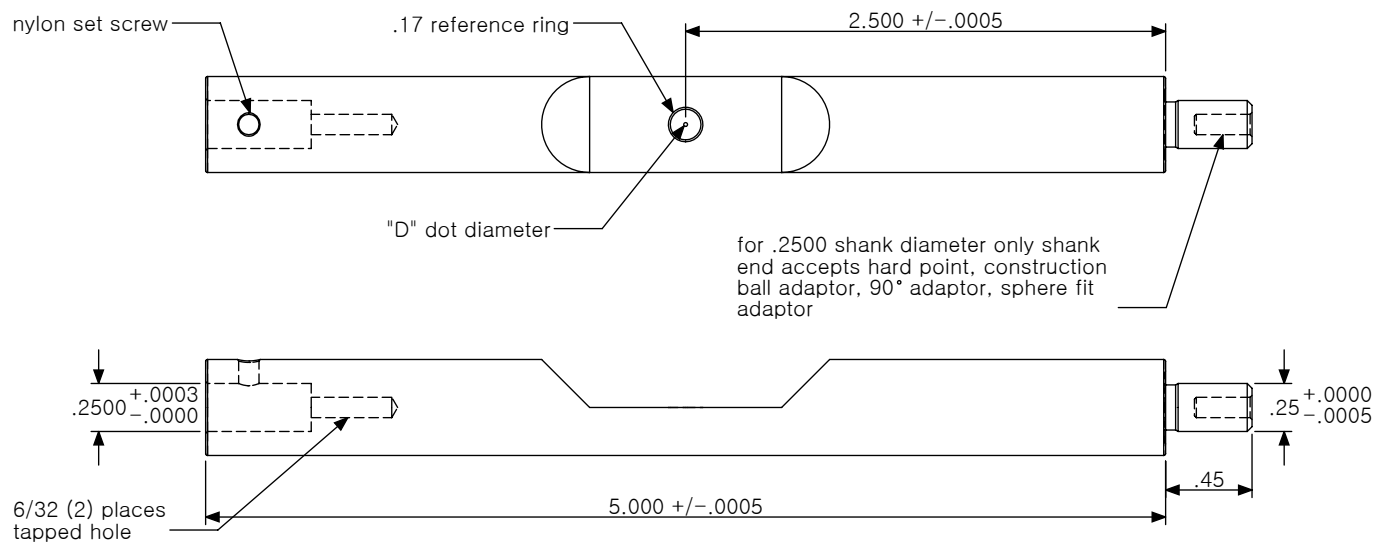

NOTES

FOR .2500 DIAMETER SHANK ONLY

If a shank diameter is needed other than .2500, adapt by using a Bar Extension 1" (BEX-1) with optional shank sizes



● RETRO - REFLECTIVE MODEL AVAILABLE

HPB/HPBR - 2.5 FEATURES
1144 STEEL, BLACK OXIDE FINISH (standard)

HPB/HPBR - 2.5 APPLICATION

Shank end accepts Hard point, Construction ball Adaptor, 90° Adaptor, and Sphere Fit Adaptor.

HPB/HPBR - 2.5 ORDERING

- For .2500 shank diameter only
- For Retro-Reflective model, order HPBR - 2.5

HPB - 4.0 and HPBR - 4.0

Used for projecting to a hidden hole or surface. The .2500 hole accepts a 90° target or bar extension. A Starrett 657TW fine adjustment flexible arm magnetic base or equivalent may be used with a Hidden Point Bar Holder (HPBH) when necessary.

HPB - 4.0 and HPBR - 4.0 ORDERING INFORMATION

	FAMILY	"D" DOT DIAMETER	MATERIAL				
HPB/HPBR-4.0 STANDARD BUILD	HPB-4.0 or HPBR-4.0		1144 steel, black oxide finish				
CUSTOMER PROVIDES INFO							
REFERENCE NOTES	_____						

HIDDEN POINT BAR and HIDDEN POINT BAR RETRO-REFLECTIVE - 4.0

CAD on file

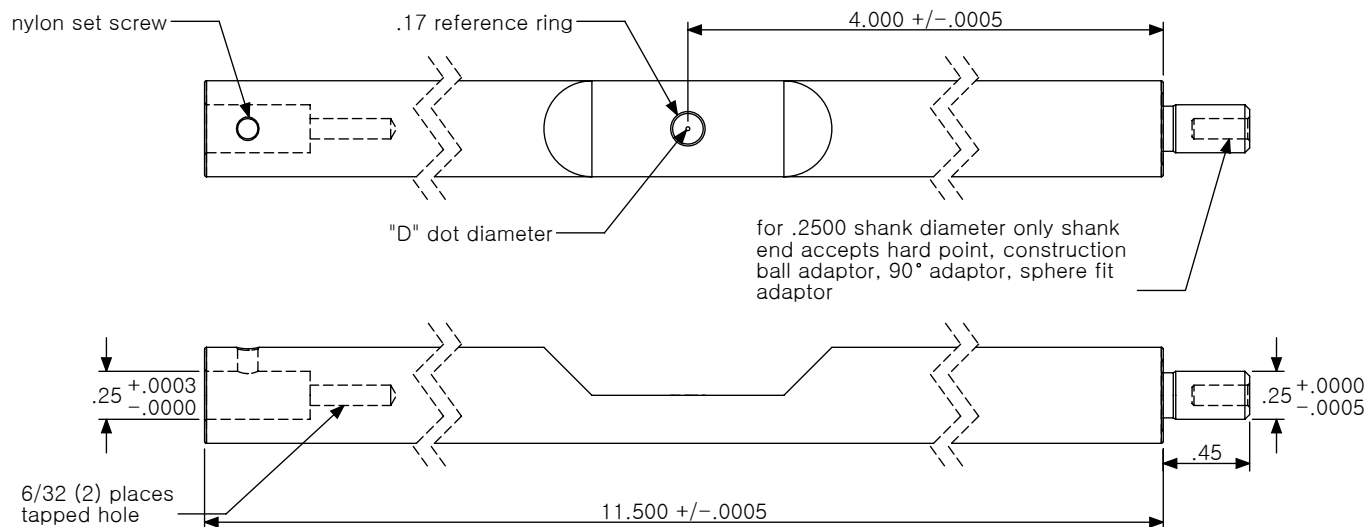

NOTES

If a shank diameter is needed other than .2500, adapt by using a Bar Extension 1" (BEX-1) with optional shank sizes.

● RETRO - REFLECTIVE MODEL AVAILABLE

HPB/HPBR - 4.0 FEATURES

1144 STEEL, BLACK OXIDE FINISH (standard)

HPB/HPBR - 4.0 ORDERING

- For .2500 shank diameter only
- For Retro-Reflective model, order HPBR - 4.0

HPB/HPBR - 4.0 APPLICATION

Shank end accepts Hard point, Construction ball Adaptor, 90° Adaptor, and Sphere Fit Adaptor.



BEX

Used with a Hidden Point Bar to extend lengths.

BEX ORDERING INFORMATION

	FAMILY	BAR LENGTH CHOICES	"A" SHANK DIAMETER	MATERIAL			
BEX STANDARD BUILD	BEX	1" or 3" or 5" or 10"	.2500 except for BEX - 1	1144 steel, black oxide finish			
CUSTOMER PROVIDES INFO	BEX	▪	▪				
REFERENCE NOTES	_____						

BAR EXTENSION

CAD on file

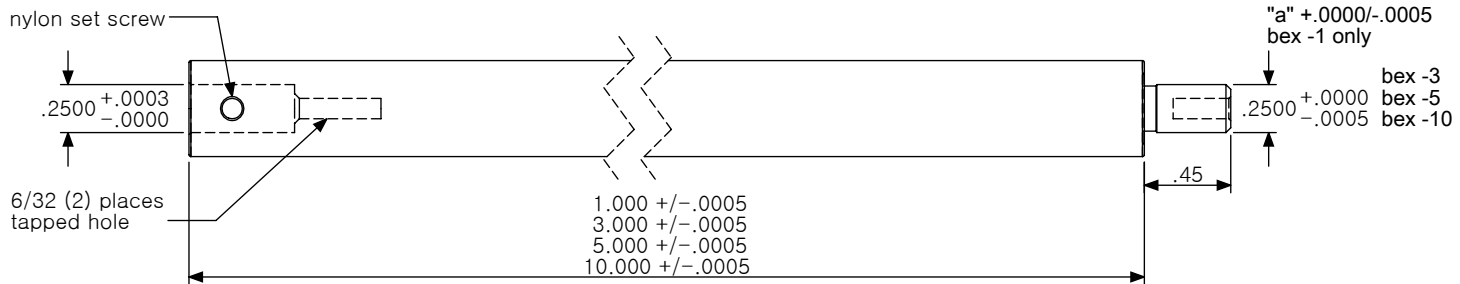

NOTES

FOR .2500 DIAMETER SHANK ONLY
EXCEPT FOR BEX - 1



BEX FEATURES

1144 STEEL, BLACK OXIDE FINISH (standard)

BEX ORDERING

"A" diameter callout for BEX - 1 only, all others have .2500 shank diameter.

BEX APPLICATION

Shank end accepts Hard Point, Construction Ball Adaptor, 90° Adaptor, and Sphere Fit Adaptor or screw together with a Hidden Point Bar using 6/32 set screw provided.

HPBH

Used for adapting a Hidden Point Bar or Bar Extension to a magnetic base for support.

HPBH ORDERING INFORMATION

	FAMILY	MATERIAL					
HPBH STANDARD BUILD	HPBH	1144 steel, black oxide, plastic					
CUSTOMER PROVIDES INFO	HPBH						
REFERENCE NOTES							

HIDDEN POINT BAR HOLDER

CAD on file



HPBH FEATURES
.375 shaft material:
1144 STEEL, BLACK OXIDE
FINISH (standard)
Block is plastic.

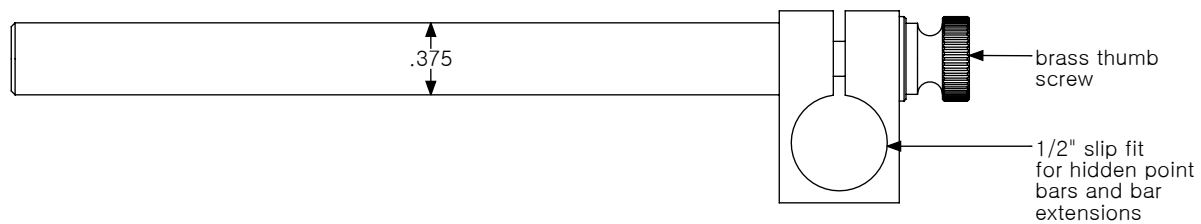

F
4

IOR

Accepts a 90° target, .500 high, .2500 shank, or .1250 shank in each end to achieve a 3.000 inch offset in each direction. For anything other than a 2.500 length in both directions, please refer to the IVOR product.

IOR ORDERING INFORMATION

	FAMILY	"A" SHANK DIAMETER	MATERIAL				
IOR STANDARD BUILD	IOR	↓	1144 steel, black oxide finish				
CUSTOMER PROVIDES INFO	IOR	■					
REFERENCE NOTES	_____						

INSERT OFFSET ROD

CAD on file

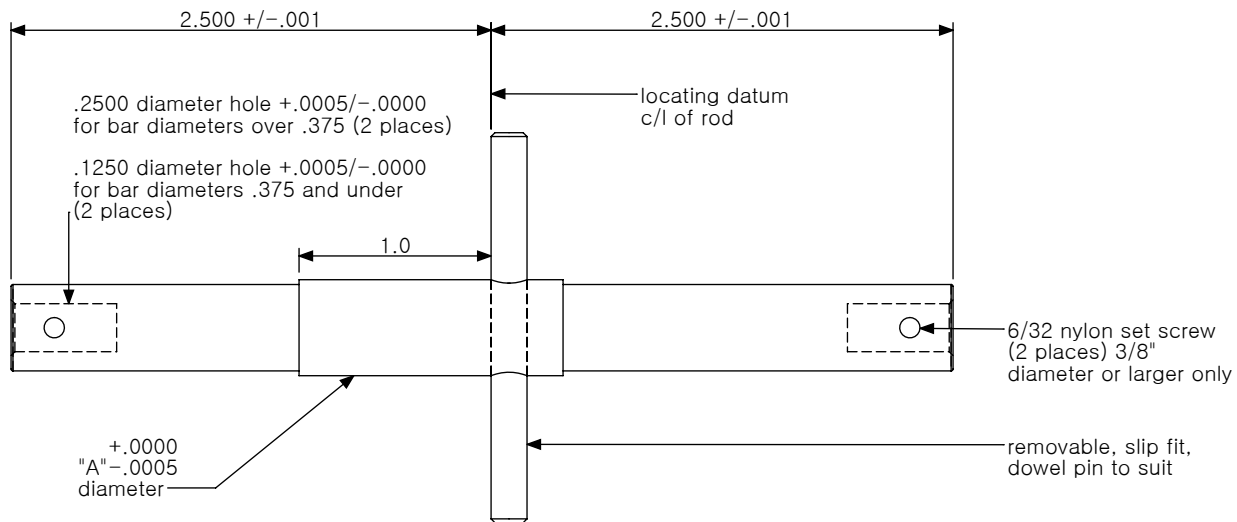

IOR FEATURES

1144 STEEL, BLACK OXIDE FINISH (standard)

ISB

Accepts a 90° target, .500 high, .2500 shank, or .1250 shank in each end to achieve a 3.000 inch offset in each direction. For anything other than a 2.500 length in both directions, please refer to the IVSB product.

ISB ORDERING INFORMATION

	FAMILY	"A" SHANK DIAMETER	MATERIAL				
ISB STANDARD BUILD	ISB		1144 steel, black oxide finish				
CUSTOMER PROVIDES INFO	ISB	■					
REFERENCE NOTES	_____						

INSERT SINE BAR

CAD on file

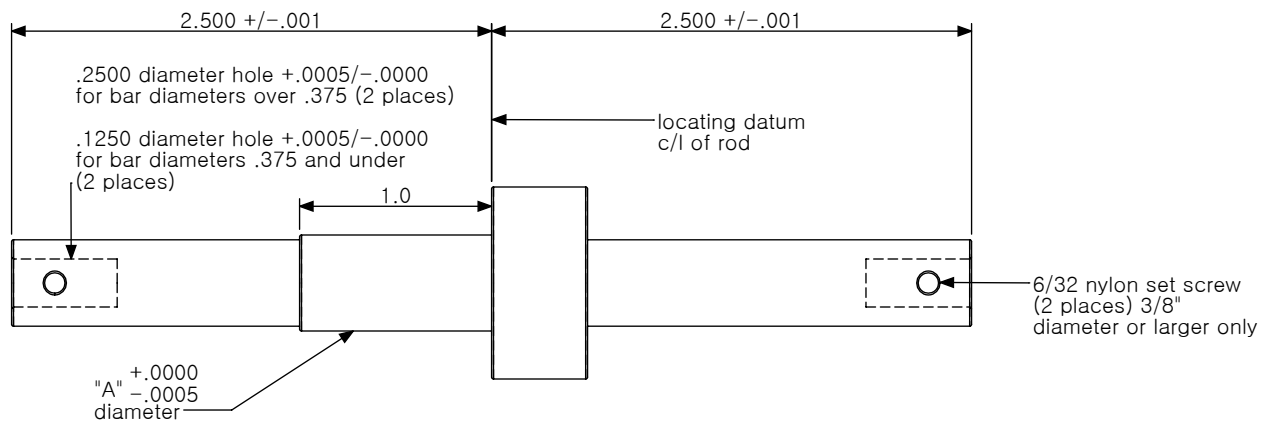

ISB FEATURES
1144 STEEL, BLACK OXIDE FINISH (standard)

6/17

IVOR

Accepts any type of stemmed target or tooling ball in each end to achieve an even inch increment offset in each direction.

IVOR ORDERING INFORMATION

	FAMILY	"A" LOCATING DIAMETER	"B" LENGTH OF DIAMETER	"C" LOCATING LENGTH	"D" LOCATING LENGTH	MATERIAL	
IVOR STANDARD BUILD	IVOR	↓	↓	↓	↓	1144 steel, black oxide finish	
CUSTOMER PROVIDES INFO	IVOR	■	■	■	■		
REFERENCE NOTES	_____						

INSERT VARIABLE OFFSET ROD

CAD on file

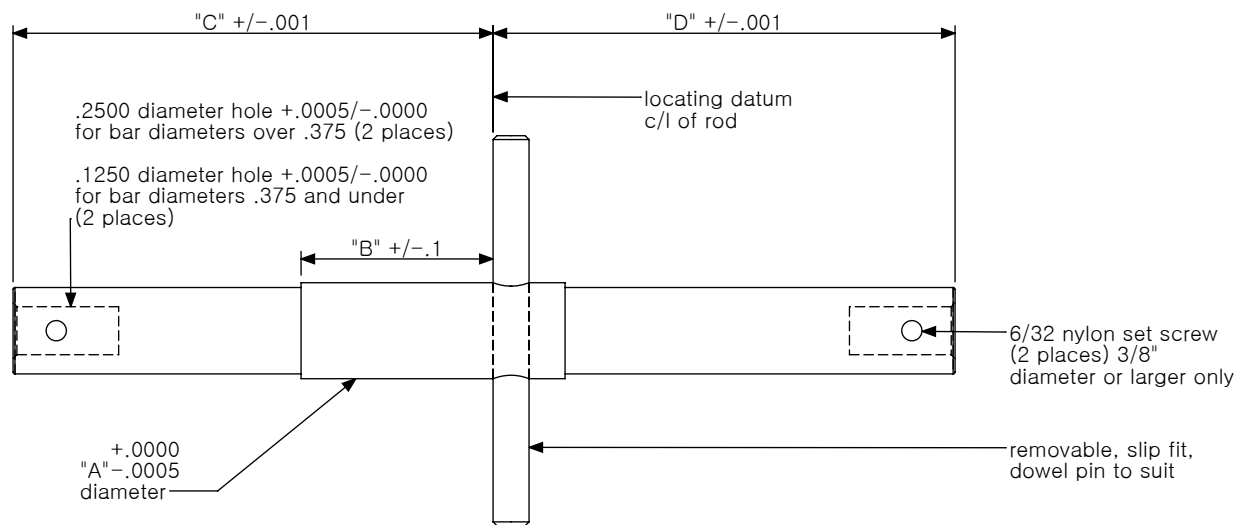

IVOR FEATURES
1144 STEEL, BLACK OXIDE FINISH (standard)

IVOR ORDERING
For custom lengths, please call for quote.

IVSB

Accepts any type of stemmed target or tooling ball in each end to achieve an even inch increment offset in each direction.

IVSB ORDERING INFORMATION

	FAMILY	"A" LOCATING DIAMETER	"B" LENGTH OF DIAMETER	"C" LOCATING LENGTH	"D" LOCATING LENGTH	"E" SHOULDER DIAMETER	MATERIAL
IVSB STANDARD BUILD	IVSB	↓	↓	↓	↓	↓	1144 steel, black oxide finish
CUSTOMER PROVIDES INFO	IVSB	▪	▪	▪	▪	▪	
REFERENCE NOTES	_____						

INSERT VARIABLE SINE BAR

CAD on file

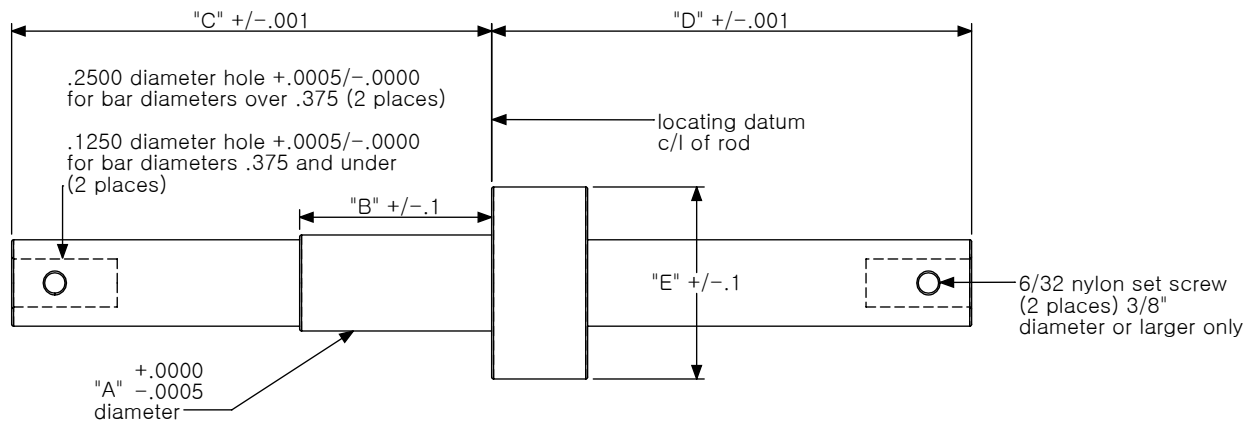

IVSB FEATURES
1144 STEEL, BLACK OXIDE FINISH (standard)

IVSB ORDERING
For custom lengths, please call for quote.

RHPA

Accepts standard .2500 or .1250 shank target to meet customer's needs.

RHPA ORDERING INFORMATION

	FAMILY	"A" DIAMETER	"B" LENGTH	"C" DIAMETER	MATERIAL		
RHPA STANDARD BUILD	RHPA	↓	↓	↓	1144 steel, black oxide finish		
CUSTOMER PROVIDES INFO	RHPA	■	■	■			
REFERENCE NOTES	_____						

REVERSE HIDDEN POINT ADAPTOR

CAD on file

NOTE

.2500 diameter hole
+.0003/-.0000, for bar
diameters over .375

.1250 diameter hole
+.0003/-.0000, for bar
diameters .375 and
under, tapped 6-32
hole omitted



RHPA FEATURES
1144 STEEL, BLACK OXIDE
FINISH (standard)

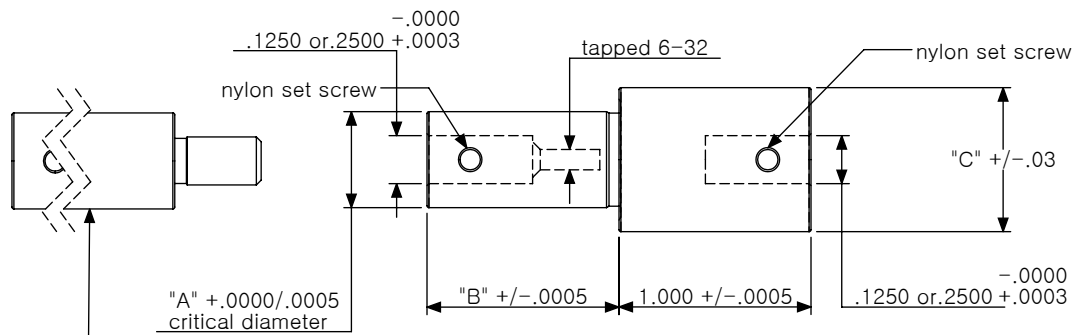

hidden point bar, bar extension or
(bex-1-1250, when used with reverse
hidden point adaptor with a .1250 hole)
reference